

# 1290 Infinity II Preparative Open-Bed Fraction Collector Tubing Kits

## Technical Note

This Technical Note describes the installation of the Fraction Collector Tubing Assemblies to the Agilent 1290 Infinity II Preparative Open-Bed Fraction Collector.

## Contents

### Tubing Kits 2

Tubing Kit G9321-60951 2

Tubing Kit G9321-60952 3

Tubing Kit G9321-60953 4

Tubing Kit G9321-60954 5

### Replace Inlet/Waste Tubings 6



# Tubing Kits

## Tubing Kit G9321-60951

1290 Inf II PrepFC Tubing Kit 200 (G9321-60951) contains the following parts:

#	p/n	Description
1	G9321-40081	Delay Sensor Clip
1	G9321-40128	Tube holder
1	5023-2878	2.4 m Tubing ESD PTFE (OD2/ID1.2)
1	5023-2636	2.4 m Tubing ESD PTFE (OD2.5/OD1.6)
2	5023-2871	Fitting 1/4-28 for Tube-OD 2.5 mm ESD-PEEK
2	5023-2872	Fitting 1/4-28 for Tube-OD 2.0 mm ESD-PEEK
1	5043-1471	Fitting Handle
5	G9321-20052	Tubing Segment
1	G9321-87712	Label Tubing IN ID1.2
1	G9321-87716	Label Tubing Out To Waste
1	5067-6785	EEPROM tag assembly
1	G9321-90120	Fract.Tubing Inl.2 Outl.6 TechNote ENG

## Tubing Kit G9321-60952

1290 Inf II PrepFC Tubing Kit 50 (G9321-60952) contains the following parts:

#	p/n	Description
1	G9321-40081	Delay Sensor Clip
1	G9321-40128	Tube holder
1	5067-6785	EEPROM tag assembly
1	5023-2637	2.4 m Tubing ESD PTFE (OD1.6/ID0.8)
1	5023-2636	2.4 m Tubing ESD PTFE (OD2.5/OD1.6)
2	5023-2871	Fitting 1/4-28 for Tube-OD 2.5 mm ESD-PEEK
2	5023-2874	Fitting 1/4-28 for Tube-OD 1.6 mm ESD-PEEK
1	5043-1471	Fitting Handle
5	G9321-20052	Tubing Segment
1	G9321-87708	Label Tubing IN ID0.8
1	G9321-87716	Label Tubing Out To Waste
1	G9321-90120	Fract.Tubing Inl.2 Outl.6 TechNote ENG

## Tubing Kit G9321-60953

1290 Inf II PrepFC Tubing Kit 8 mL (G9321-60953) contains the following parts:

#	p/n	Description
1	G9321-40081	Delay Sensor Clip
1	G9321-40128	Tube holder
1	5067-6785	EEPROM tag assembly
1	5023-3072	2.4 m Tubing ESD PTFE (OD1.6/ID0.5)
1	5023-2636	2.4 m Tubing ESD PTFE (OD2.5/OD1.6)
2	5023-2874	Fitting 1/4-28 for Tube-OD 1.6 mm ESD-PEEK
2	5023-2871	Fitting 1/4-28 for Tube-OD 2.5 mm ESD-PEEK
1	5043-1471	Fitting Handle
5	G9321-20052	Tubing Segment
1	G9321-87716	Label Tubing Out To Waste
1	G9321-87705	Label PrepFC Tubing IN ID 0.5
1	G9321-90120	Fract.Tubing Inl.2 Outl.6 TechNote ENG

## Tubing Kit G9321-60954

1290 Inf II PrepFC Tubing Kit 150 mL (G9321-60954) contains the following parts:

#	p/n	Description
1	G9321-40081	Delay Sensor Clip
1	G9321-40128	Tube holder
1	5067-6785	EEPROM tag assembly
1	5023-2878	2.4 m Tubing ESD PTFE (OD2/ID1.2)
1	5023-2636	2.4 m Tubing ESD PTFE (OD2.5/OD1.6)
1	G9321-87713	Label Tubing IN ID1.2
1	G9321-87716	Label Tubing Out To Waste
5	G9321-20052	Tubing Segment
2	5023-2871	Fitting 1/4-28 for Tube-OD 2.5 mm ESD-PEEK
2	5023-2872	Fitting 1/4-28 for Tube-OD 2.0 mm ESD-PEEK
1	5043-1471	Fitting Handle
1	G9321-90120	Fract.Tubing Inl.2 Outl.6 TechNote ENG

# Replace Inlet/Waste Tubings

Parts required	#	p/n	Description
	1	G9321-60951	1290 Inf II PrepFC Tubing Kit 200 for flow rates up to 200 mL/min
OR	1	G9321-60952	1290 Inf II PrepFC Tubing Kit 50 for flow rates up to 50 mL/min
OR	1	G9321-60953	1290 Inf II PrepFC Tubing Kit 8 mL for flow rates up to 8 mL/min
OR	1	G9321-60954	1290 Inf II PrepFC Tubing Kit 150 mL for flow rates up to 150 mL/min

**Preparations** Move to **Change Tubing Position** via Lab Advisor.

**1** Open and remove the top fume hood.

**a** Swing up the fume hood against the mechanical stop.

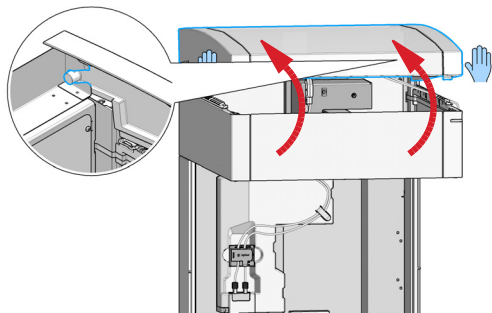

**b** Remove the fume hood by pulling it toward you.

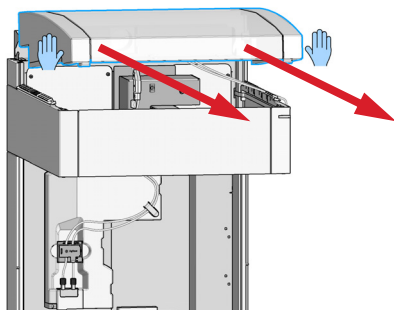

**2** Open the tube holder.

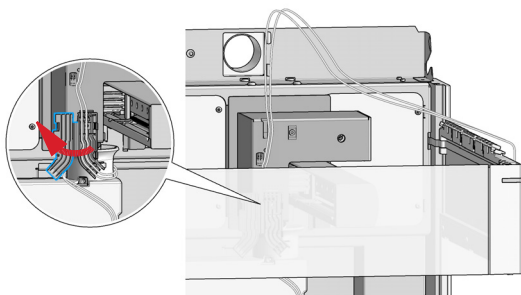

**3** Remove the tubings from the tube holder.

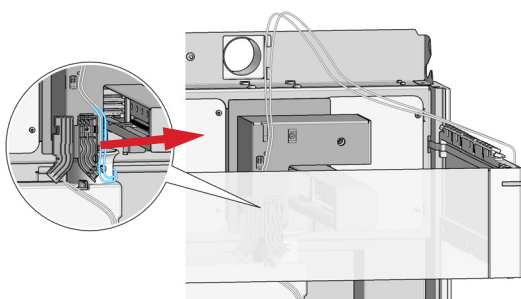

**4** Remove tubing clip and dongle from the fraction collector.

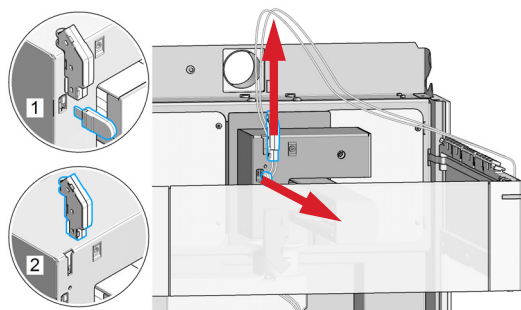

**5** Remove the Inlet/Waste Tubings from the capillary holder.

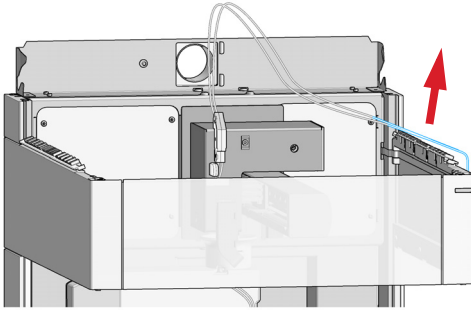

**6** Remove the tubings from under the clamp at the robotics arm.

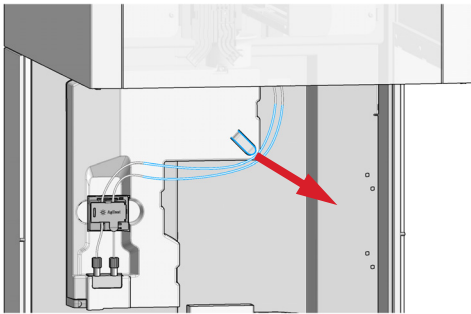

**7** Remove the delay sensor holder: Unlock the device with the lever (1.), then pull out (2.).

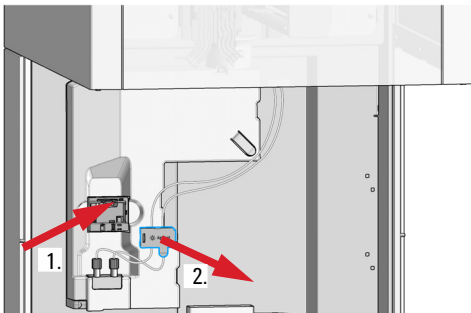

**NOTE**

Do not remove the delay sensor holder from the tubing.



**8** Unscrew the tubings from the valve assembly.

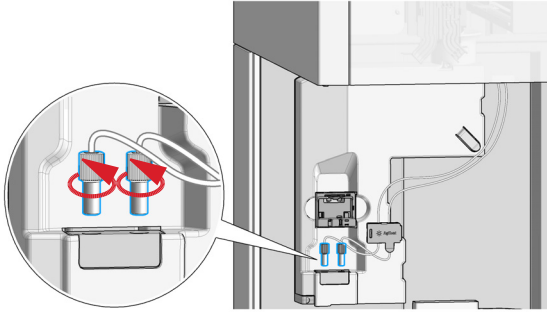

**9** Screw the tubings of the new inlet/waste tubing kit into the valve assembly. Tighten the fittings finger-tight, then use the Fitting handle (about ¼ turn).

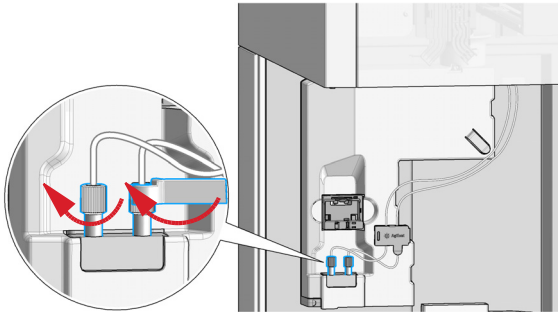

**10** Install the delay sensor holder.

**NOTE**

Make sure that the holder is fixed properly. Press the small button to insert the tubing properly.

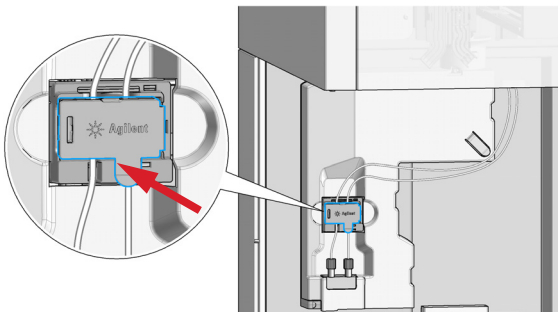

**11** Route the tubings under the clamp at the robotics arm.

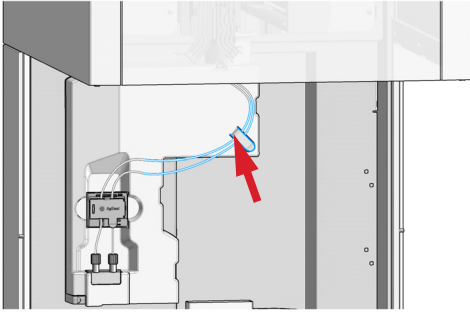

**12** Route the tubings clockwise (one turn) around the robotics arm.

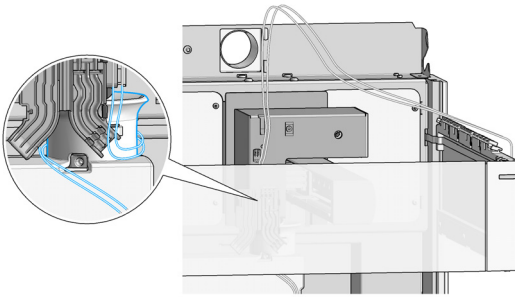

**13** Push the clip into the housing and connect the dongle.

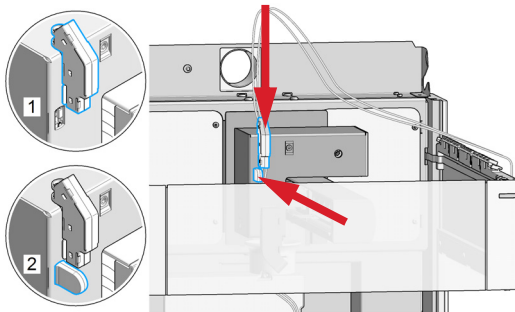

**14** Install the tubings to the tube holder.

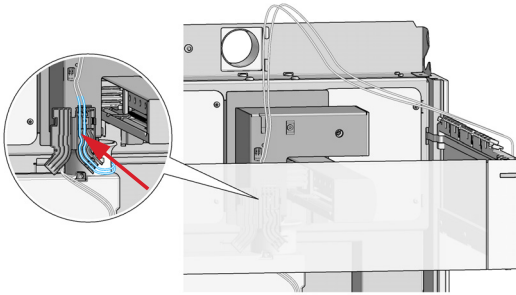

**15** Close the tube holder.

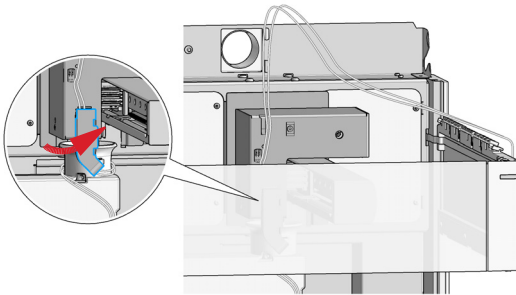

**16** Install the Inlet/Waste Tubings to the capillary holder. Position them approximately in the middle of the capillary holder.

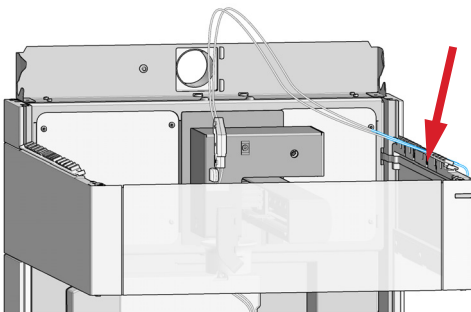

**17** Install the top fume hood and close it.

**a** Push the top fume hood into the recession.

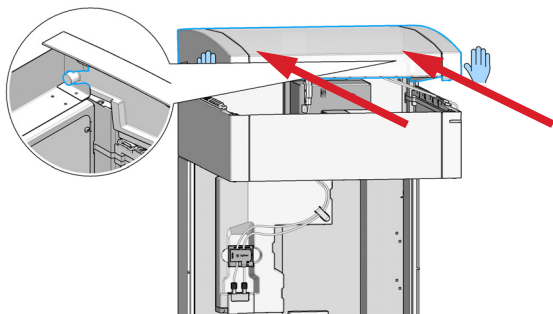

**b** Close the top fume hood.

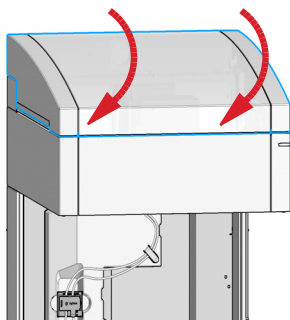

G9321-90120

Part Number:  
G9321-90120 Rev. E

Edition: 12/2017  
Printed in Germany

© Agilent Technologies, Inc 2016,  
2017

Agilent Technologies, Inc  
Hewlett-Packard-Strasse 8  
76337 Waldbronn, Germany